

Renovation Project

St. Clement's Island Museum



Presented by
St. Mary's County
Recreation & Parks

November 25, 2024



St. Clement's Island Museum



St. Clement's Island Museum rests on the east shore of the Potomac River overlooking St. Clement's Island, Maryland's First Colonial Landing in 1634. The museum's mission concentrates on Maryland's earliest history and Potomac River heritage.

The museum focuses on the English history that preceded the voyage to Maryland relating the religious and political issues of the 16th and 17th centuries. Here, visitors can discover the vision of George Calvert, the First Lord Baltimore, to found a colony incorporating religious views of tolerance and his sons' implementation of this vision.

Visitors will learn of the voyage of the Ark and the Dove departing from the Isle of Wight in England on the feast day of St. Clement, the patron saint of mariners, following their treacherous crossing of the Atlantic Ocean, braving pirates and dangerous storms, and their venture up the Chesapeake Bay to the Potomac River.

The museum is also host to an authentic historic watercraft, the Doris C, a Potomac River dory boat that worked the waters of the Potomac for decades in the early 1900s.

The Friends of the St. Clement's Island & Piney Point Museums raise funds in order to support historical interpretation, education programs, and special needs of the sites managed by the Museum Division of St. Mary's County Department of Recreation and Parks



Hours of Operation

Open Daily

10:00 A.M. – 5:00 P.M.

*Closed Thanksgiving Day,
Christmas Eve & Christmas Day*

Project Highlights



Two-Story Building

Total 10,930 square feet building, built on the same foot print as previous building.

Offices & Meeting Space

Large multipurpose room, research library; children's area, staff offices and more!

Museum Store

Store operated by the Friends of St. Clements Island and Piney Point Museums.

Exhibit Space

Exhibit will focus on Maryland's founding from both English and Piscataway perspectives.

ADA Accessible

All facility amenities designed for maximum universal accessibility.

Outdoor Exhibits

All exhibits and outdoor amenities will remain.

Current Museum Property





New Building

Located on the same footprint as old building.

Two story, 10,930 Square feet

Over 1,300 square feet of new decking



ST CLEMENT'S ISLAND MUSEUM

NEW BUILDING



1st Floor

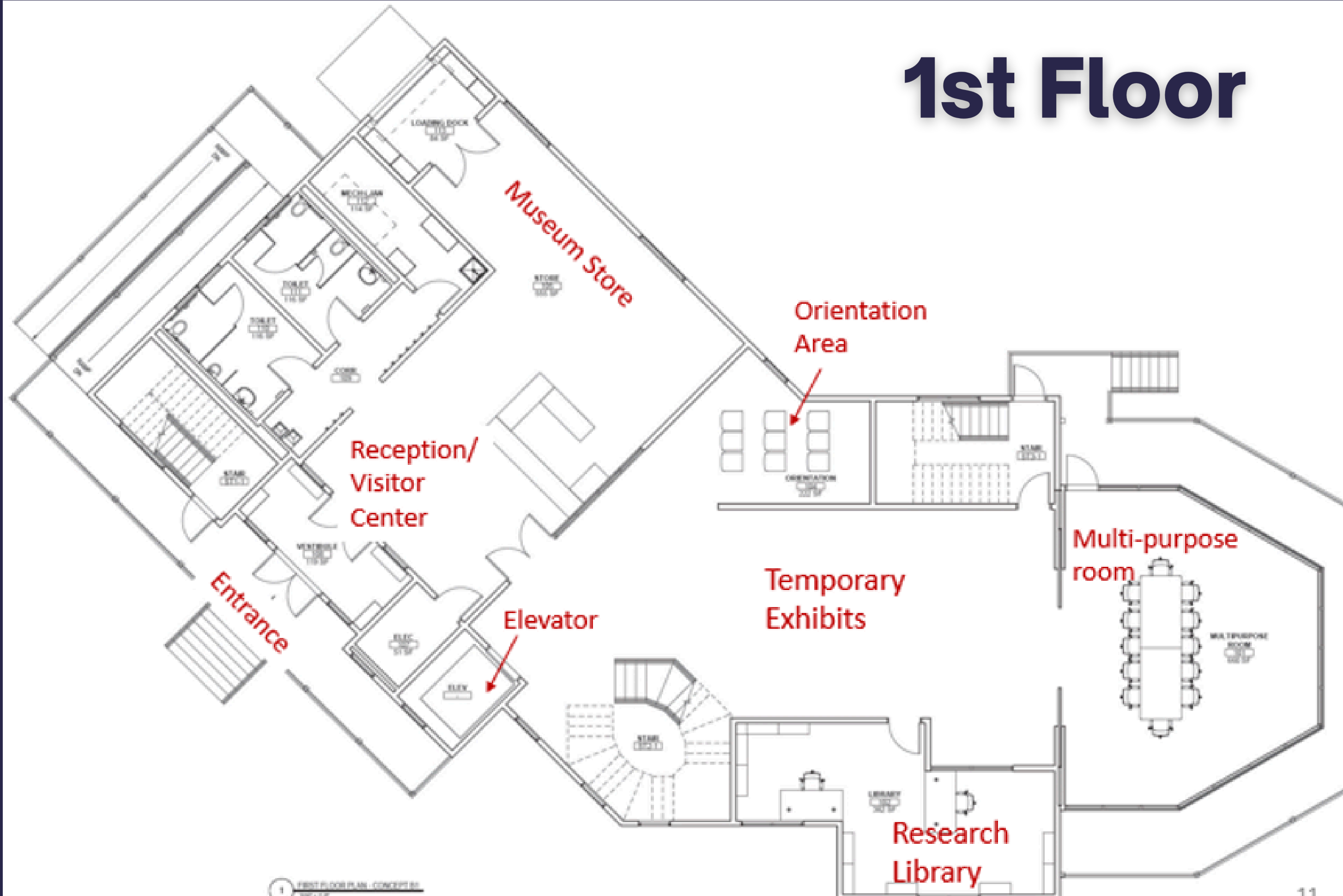



2nd Floor

Staff Offices and Breakroom

Permanent Exhibit: Through
Piscataway Eyes and
Through English Eyes

Please Touch
Room

SHIPS

BENCH

CASE

CASE

Exhibits



The new exhibit space totaling 2,598 square feet, will provide a complete foundation story from both the English perspective and the Piscataway perspective, including the reasons for leaving England.

- Additional artifacts, including a number of native objects from the Smithsonian collections and the Piscataway people.
- An orientation theater for viewing film on a variety of interpretations and providing tours of the Blackistone Lighthouse during the off-season.
- A glass sided first floor meeting room.
- A glass sided room for hands-on options to touch objects and try on costumes.
- Potential option to add solar panels





Timeline



November 2024

Procurement

- Final plans from architect
- Draft documentation finalized and reviewed by Legal
- Presentation to Commissions with approval for funding
- 60-days to bid

January 2025

Solicitation for Bid

- Posted for public review
- Open for bids
- Review of bids with total process completed in approximately 12-weeks

Mid Year 2025

Ground Breaking

- Approximately 45-days after bids are reviewed and approved
- As early as April 2025

July 2026

Target Completion

- Approximately 15-months to complete construction



ST. CLEMENTS ISLAND MUSEUM CONSTRUCTION

For Project Updates

Follow
-US- → → →



@stclementsismuseum

#SCIMuseum

www.stmaryscountymd.gov/recreate/Museums

Project approved by Commissioners of St. Mary's County

